

# KANSAS SCHOLASTIC PRESS ASSOCIATION

## REGIONAL HIGH SCHOOL JOURNALISM CONTEST

Wichita State University • Rhatigan Student Center  
Feb. 25, 2016

## WELCOME, STUDENT JOURNALISTS

### 1A/2A

Burrton  
Canton-Galva  
Chase County  
Greensburg Kiowa  
County  
Skyline

### 5A/6A SUNFLOWER (K)

Campus  
Eisenhower  
Kapaun Mt. Carmel  
Goddard High School  
Salina Central  
Salina South  
Wichita East  
Wichita Southeast

### 5A/6A BLACK (L)

Andover  
Bishop Carroll  
Derby  
Maize  
Newton  
Wichita Northwest  
Wichita West

**8:15 - 9 a.m. Check-in**.....Aster Lounge (3rd)

**9 Opening** .....Beggs Ballroom  
Amy DeVault, contest director

**9:30 - 11 Adviser meeting** ..... Gridley (301)

### 9:30 - 11 1A/2A & 5A/6A BLACK

Copy Editing.....Prairie (313)  
Sports Writing (newspaper) ..... Pike (266)  
Editorial Cartoon ..... Venters (314)  
Yearbook Copy ..... McKay (319)  
Feature Writing.....Santa Fe (233)

### 5A/6A SUNFLOWER

News Writing .....Ballroom 1 (east)  
Cutline Writing..... Warner (207)  
Editorial Writing..... Spencer (264)  
Yearbook Sports..... Ballroom 2 (west)

### 11:10 - 12:40 1A/2A & 5A/6A BLACK

News Writing ..... Pike (266)  
Cutline Writing..... McKay (319)  
Editorial Writing..... Prairie (313)  
Yearbook Sports..... Spencer (264)

### 5A/6A SUNFLOWER

Copy Editing.....Ballroom 1 (east)  
Sports Writing (newspaper) ..... Santa Fe (233)  
Editorial Cartoon ..... Venters (314)  
Yearbook Copy ..... Warner (207)  
Feature Writing..... Ballroom 2 (west)

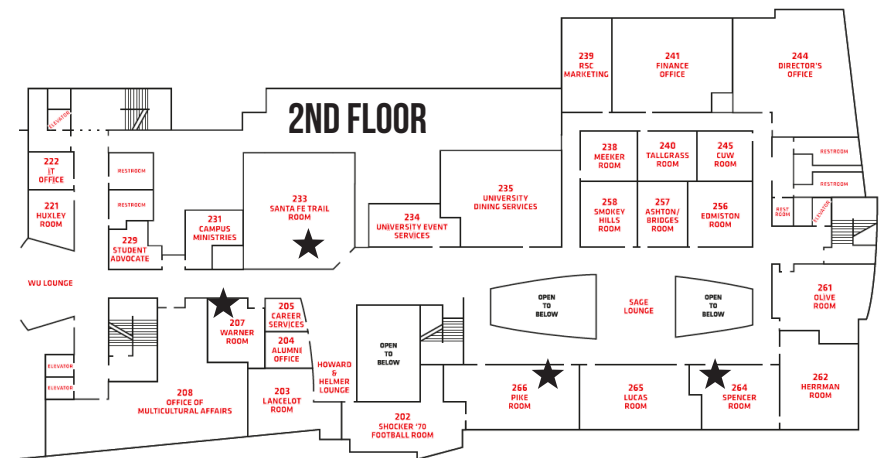

## RHATIGAN STUDENT CENTER

### 1ST FLOOR DINING

Erbert & Gerbert's  
Taco Bell  
Chick-fil-A  
Pizza Hut  
Fast Break

### BASEMENT

Shocker Lanes  
Bar & Grill

